

# LCD Ceiling Mount

For 13" to 29" LCD Screens

## MODELS

### Universal Models:

Includes theft resistant hardware for attaching screen to mount

<b>LCC-18</b>	Black
<b>LCC-18S</b>	Silver
<b>LCC-36</b>	Black
<b>LCC-36S</b>	Silver

### Universal Models with Cable Management Covers:

Includes theft resistant hardware for attaching screen to mount

<b>LCC-18-C</b>	Black
<b>LCC-18-CS</b>	Silver
<b>LCC-36-C</b>	Black
<b>LCC-36-CS</b>	Silver

## SCREEN ADAPTER



### VESA® pattern

Universal Models: 75 and 100 mm

## SPECIFICATIONS



### Distance from ceiling

<b>LCC-18(S):</b>	19.35"-32.35" (491-822 mm)
<b>LCC-18-C(S):</b>	20.26"-33.26" (515-845 mm)
<b>LCC-36(S):</b>	36.85"-49.85" (936-1266 mm)
<b>LCC-36-C(S):</b>	37.76"-50.76" (959-1289 mm)



### Tilt | Swivel

+20/-5° | 360°



### Max load

40 lb (18 kg)

### Product Dimensions (W x H x D)

<b>LCC-18(S):</b>	5" x 19.35"-32.35" x 3" (127 x 491-822 x 76 mm)
<b>LCC-18-C(S):</b>	6.33" x 20.26"-33.26" x 6.33" (161 x 515-845 x 161 mm)
<b>LCC-36(S):</b>	5" x 36.85"-49.85" x 3" (127 x 936-1266 x 76 mm)
<b>LCC-36-C(S):</b>	6.33" x 37.76"-50.76" x 6.33" (161 x 959-1289 x 161 mm)

### Mounting Surfaces

Wood stud, concrete  
and various other applications  
(Requires accessory)

### Ship Weight

<b>LCC-18(S):</b>	4.6 lb (2.1 kg)
<b>LCC-18-C(S):</b>	7.3 lb (3.3 kg)
<b>LCC-36(S):</b>	6.2 lb (2.8 kg)
<b>LCC-36-C(S):</b>	10.6 lb (4.8 kg)

## CERTIFICATIONS



## ACCESSORIES



**ACC, CMJ, DCS, DCT Models:**  
Ceiling Plates ..... pg# xxx-xxx



**AEC, EXT Models:**  
Ceiling Extensions ..... pg# 127

1. VESA® 75 and 100 compliant
2. Non-VESA® screen adapter plates also available
3. Cable management cover models available for a clean look
4. Adjustable height in 1" (25 mm) increments:  
LCC-18 models  
19.35"-32.35" (491-822 mm)  
or LCC-36 models  
36.85"-49.85" (936-1266 mm)
5. +20/-5° tilt
6. 0.75" (19 mm) extension pipe for low-profile appearance
7. Portrait or landscape orientation
8. Mounts in standard or face-down screen position
9. Includes adapter to 1.5" (38 mm) NPT pipe



## TECHNICAL DRAWINGS

For expanded product information and technical data visit [www.peerlessmounts.com](http://www.peerlessmounts.com)

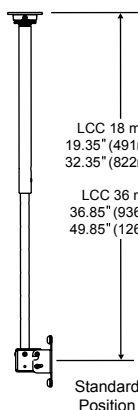

LCC 18 models  
19.35" (491mm) min.  
32.35" (822mm) max.  
  
LCC 36 models  
36.85" (936mm) min.  
49.85" (1266mm) max.

Standard Position

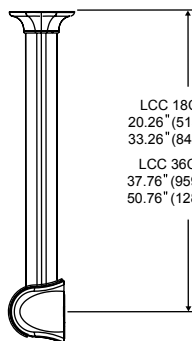

LCC 18C models  
20.26" (515mm) min.  
33.26" (845mm) max.  
  
LCC 36C models  
37.76" (959mm) min.  
50.76" (1289mm) max.

Standard Position  
With Cover

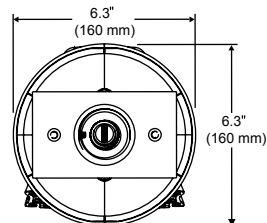
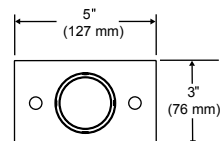

To verify mount compatibility with any LCD, plasma or projector model use MountFinder™ at [www.peerlessmounts.com](http://www.peerlessmounts.com)



**CLICK:** [www.peerlessmounts.com](http://www.peerlessmounts.com)



**CALL:** 800.865.2112



**FAX:** 708.865.2941